

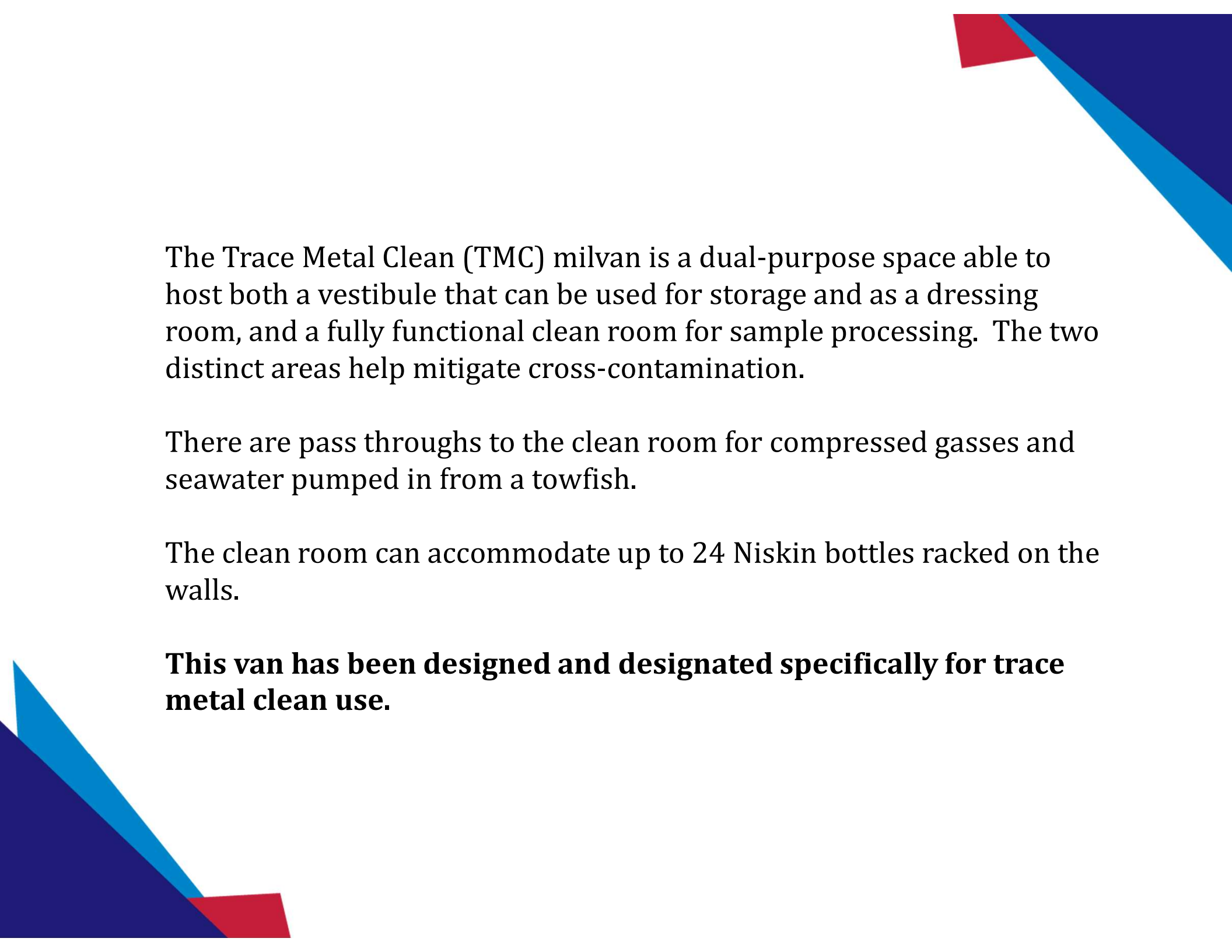

Trace Metal Clean Van #7

Updated 22 April 2024





The Trace Metal Clean (TMC) milvan is a dual-purpose space able to host both a vestibule that can be used for storage and as a dressing room, and a fully functional clean room for sample processing. The two distinct areas help mitigate cross-contamination.

There are pass throughs to the clean room for compressed gasses and seawater pumped in from a towfish.

The clean room can accommodate up to 24 Niskin bottles racked on the walls.

This van has been designed and designated specifically for trace metal clean use.

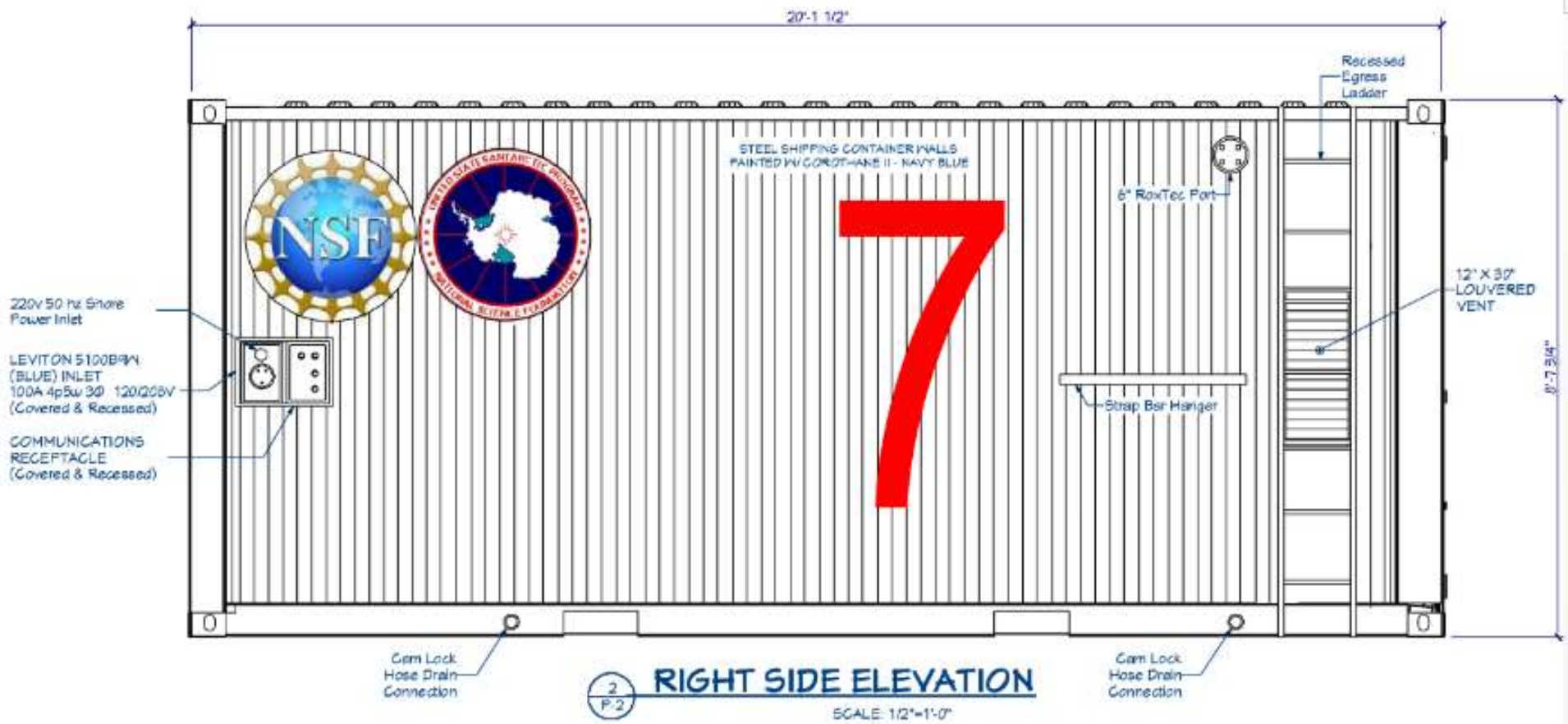

TMC Van #7. New 2018.
 Hammelman Communications
 Pagosa Springs, Colorado

TMC Van #7 Features and Technical Information

General

Owner	National Science Foundation
Manufacturer	Hammelman Communications
Purchased	2018
Condition	Excellent

Specifications

Length Overall	20 ft
Width	8 ft
Electrical	6 ea. 110V 20 amp outlets 3 ea. 208V 15 amp single phase power
Ventilation	Forced heat air with 3 in. insulated walls

Installed Equipment

Clean Room and Vestibule, Separated by Partition Wall
Bard Forced Air Heater
HEPA Mac 10 Laminar Flow Hoods, in Ceiling 25-40 FPM at Work Surface (633 – 1056 CFM)
Pass Throughs/Rox Blocks for Compressed Gasses or Water
Drain in Floor for discharging Niskin Bottles
Windows and Emergency Egress Hatch
Foldable Phenolic Resin Benchtops on both sides
Fiberglass Strut for Hanging Niskins in Clean Room
Fire Extinguishers, Spill Cleanup, Eyewash in Vestibule
Secondary containment in Vestibule
UNOLS RVSS compliant
Not plumbed for running water

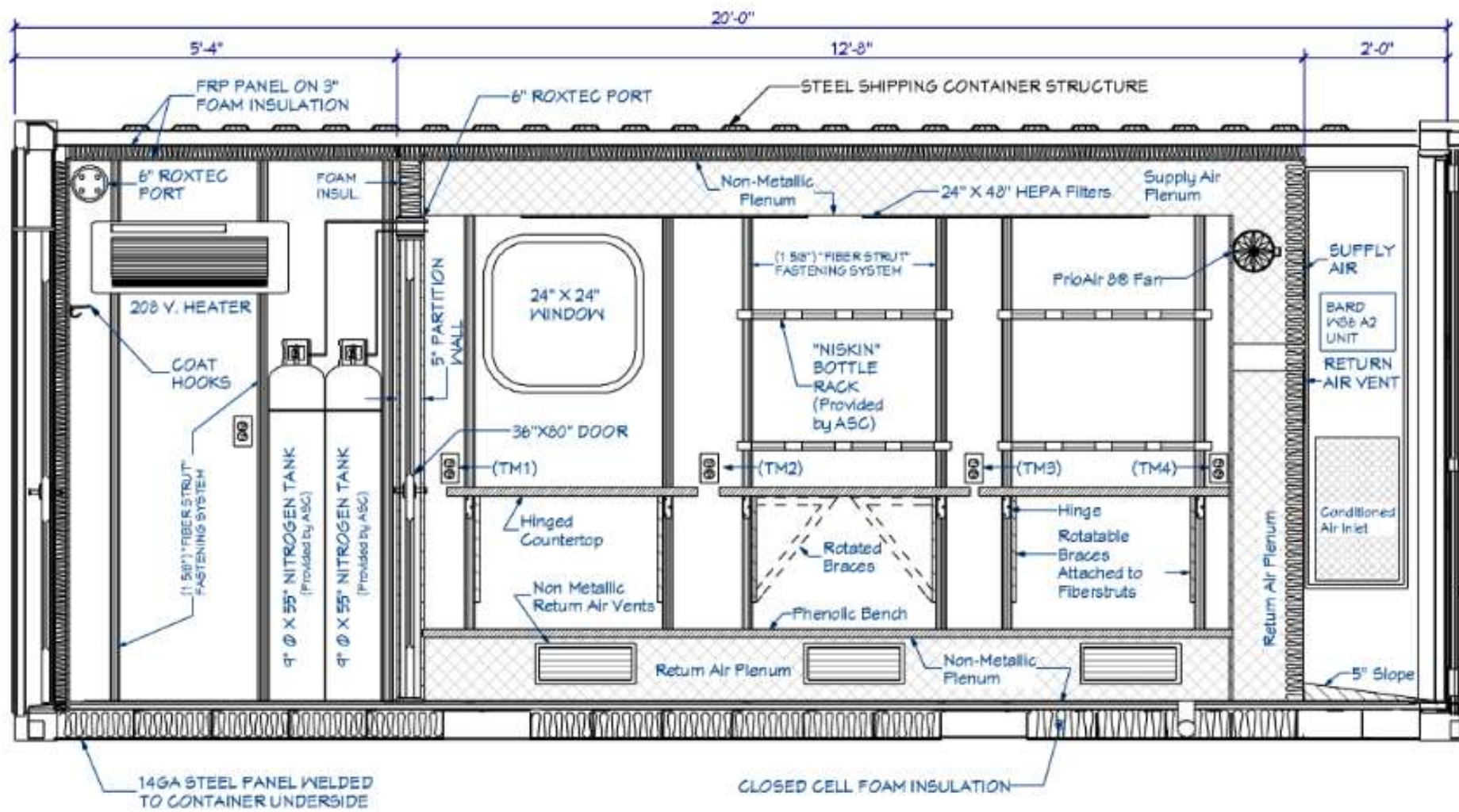

2
F-9

INTERIOR WALL ELEVATION / SECTION

SCALE: 1/2"=1'-0"

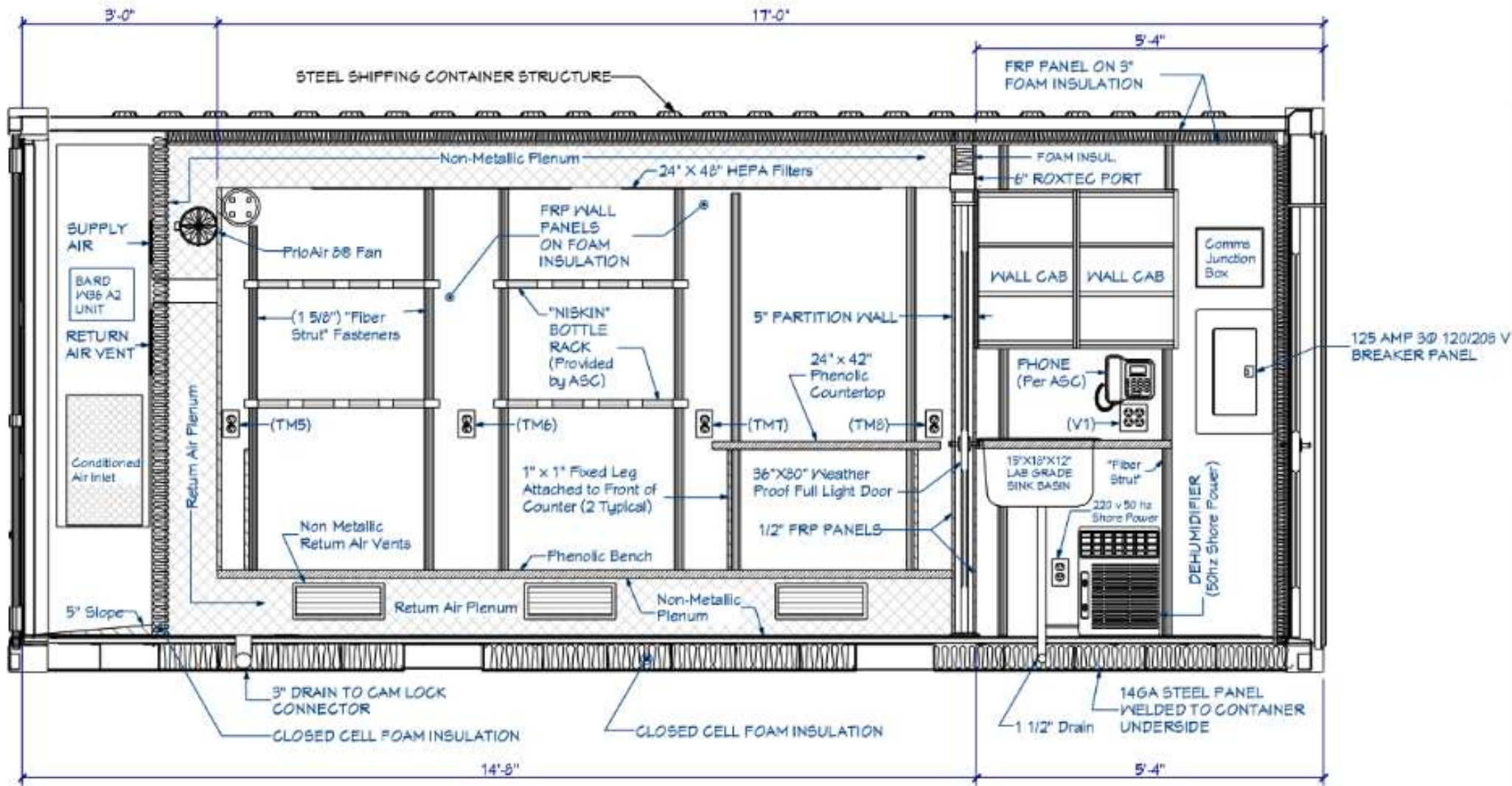

4
P-3

INTERIOR WALL ELEVATION / SECTION

SCALE: 1/2"=1'-0"

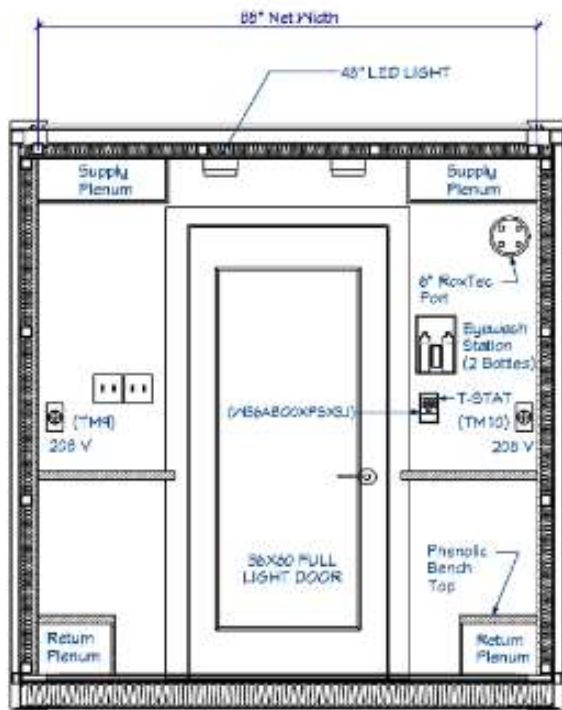

2 PARTITION WALL ELEVATION
SCALE: 1/2"=1'-0"

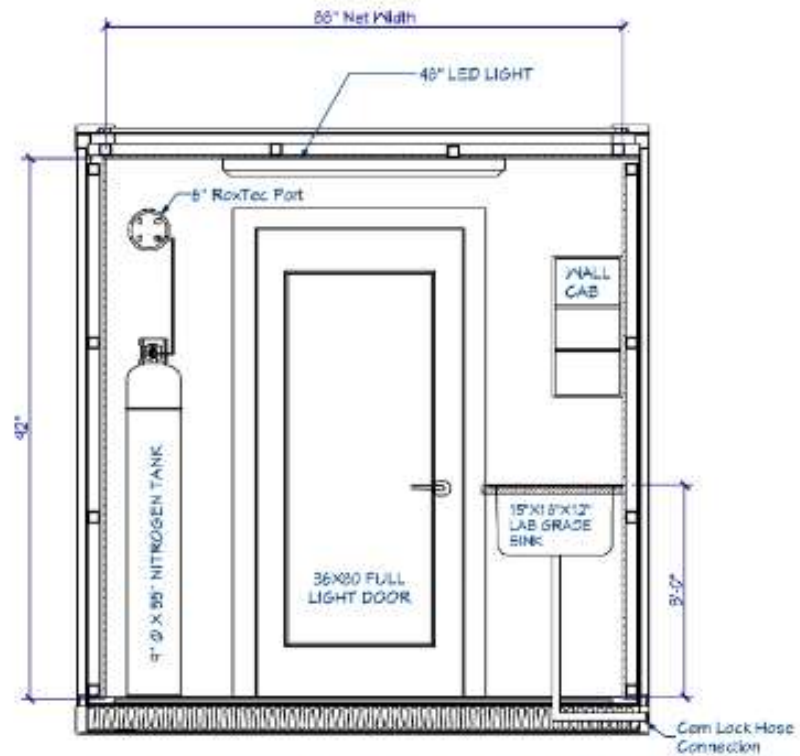

3 PARTITION WALL ELEVATION
SCALE: 1/2"=1'-0"

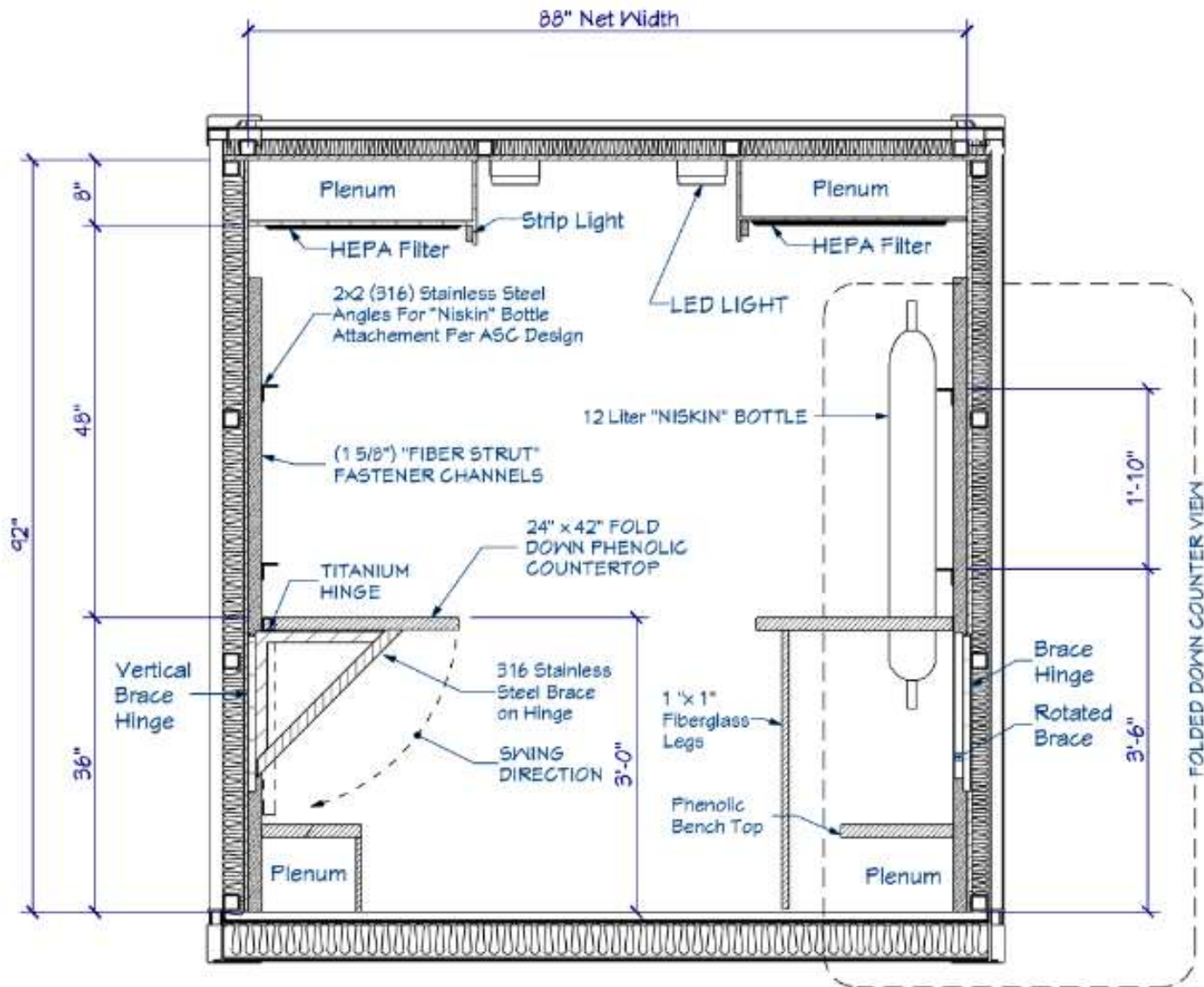

1
P-4

VAN CROSS SECTION / DETAIL

SCALE: 3/4"=1'-0"





